

TOYOTA POWER RACK & PINION ASSEMBLY

TOYOTA CAMRY 1/83-7/86 <u>QUANTITY</u>	TOYOTA CELICA CELICA SUPRA 1982-85 <u>QUANTITY</u>	<u>DESCRIPTION</u>
0	1	Pinion Cap O-Ring
1	2	Hsg. to Hsg. O-Ring
1	1	Bulkhead O-Ring
1	1	Pinion Hsg. O-Ring
4	4	Valve Sealing Ring
1	1	Rack Piston O-Ring
1	1	Rack Piston Sealing Ring
1	1	Upper Pinion Seal
1	2*	Lower Pinion Seal
1	1	Outer Rack Seal
1	1	Inner Rack Seal
2	2	Bellows Clamp - Large
2	2	Bellows Clamp - Small

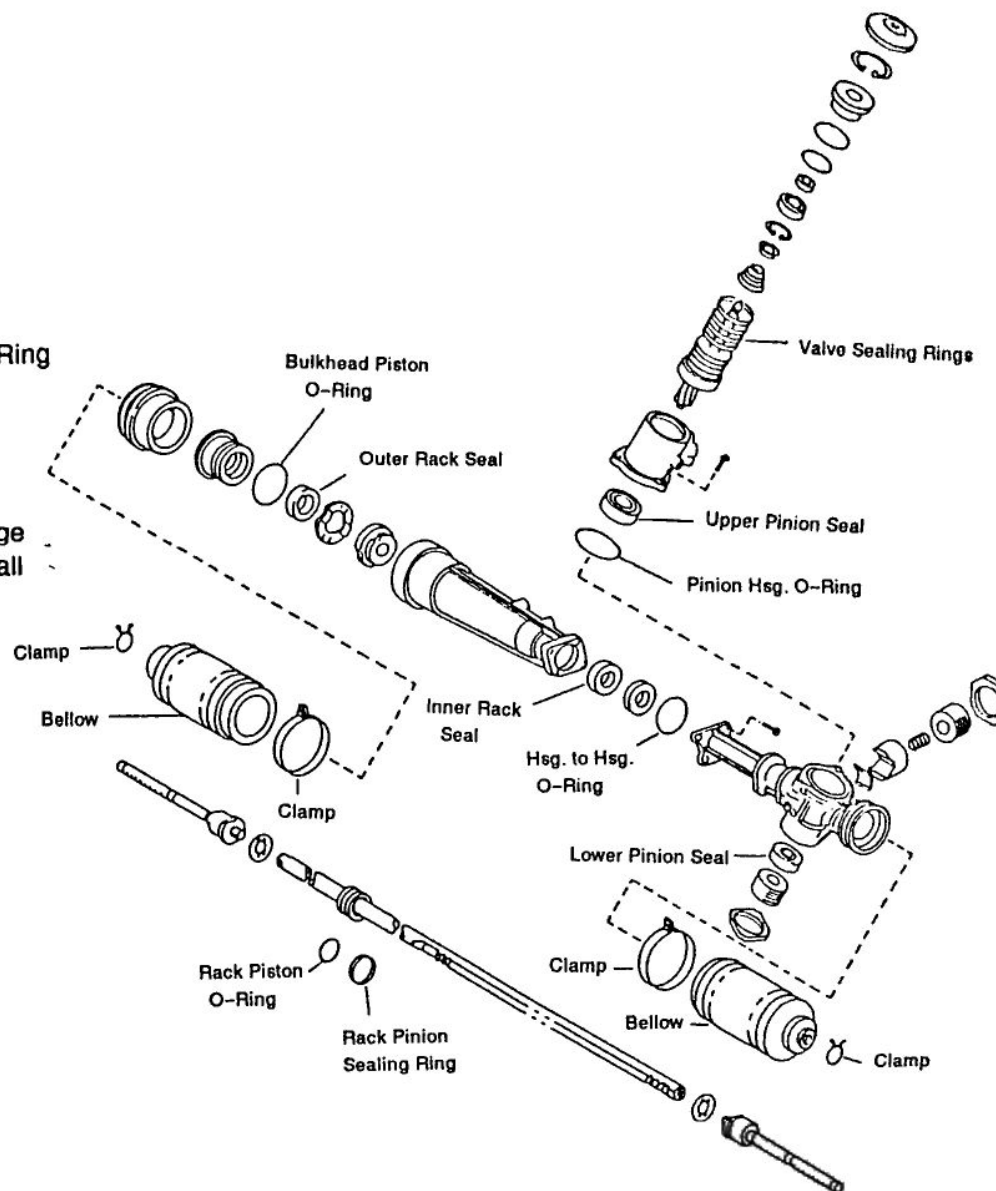

NOTES: 0 Denotes parts not required for this assembly
 * Denotes early and late design lower pinion